

REMINGTON®

XR7000

Use and Care Guide



Register Your New Product Today!

By registering your new Remington® product, you will receive special offers.
Register online at: RemingtonProducts.com

IMPORTANT SAFETY INSTRUCTIONS

When using an electrical appliance, basic precautions should always be observed, including the following. **Please read all instructions before using this shaver.**

WARNINGS

To reduce the risk of burns, fire, electric shock, or injury to persons:

- When connecting the charging unit to a power source outside of the USA or Canada, use a plug adapter suitable for the power outlet. This device has a charging adaptor that will work with worldwide 100V-240V power outlets.
- Only use the power adapter provided with this device.
- Do not reach for the appliance if it has fallen into water while plugged into the power source. Unplug from the power source at the wall immediately.
- Shaver may be rinsed under water or used in the shower, but never use the charging unit in the shower.
- Detach the shaver and charging unit from the power source before cleaning.
- Except when charging, always unplug this appliance immediately after using.
- When recharging place in a safe position, out of the reach of children and pets.

- Close supervision is necessary when this appliance is used by, on, or near children or individuals with certain disabilities or special needs.

- Use this appliance only for its intended use as described in this manual.

- Do not use attachments not recommended or provided by the supplier.
- Never operate this appliance if the electrical cord is frayed or the plug is damaged.
- Keep the electrical cord away from heated surfaces.
- Never drop or insert objects into any of the appliances openings.
- This appliance is intended for household use only.
- Do not use outdoors, or operate where aerosol (spray) products are being used, or where oxygen is being administered.
- Always attach the plug to the appliance, then to the wall outlet. To disconnect, turn all controls to OFF, then remove plug from outlet.
- Always pull on the plug body to unplug the appliance from the wall socket. Never pull on the electrical cord.
- Do not plug in or unplug this appliance when your hands are wet.
- Do not use extension cords or a voltage converter with this appliance.
- Do not wrap the power cord around the appliance.
- Always store the appliance and charger in low moisture area.
- Do not expose the appliance to temperatures over 140° F (60° C).
- Detach removable power cords from the appliance during storage.
- Do not use this shaver if the cutting head surfaces are damaged or broken as skin injury could occur.
- This shaver and trimmer are intended for use on scalp hair only. It should not be used for facial hair or longer hair on your body.

SAVE THESE INSTRUCTIONS

PRODUCT FEATURES

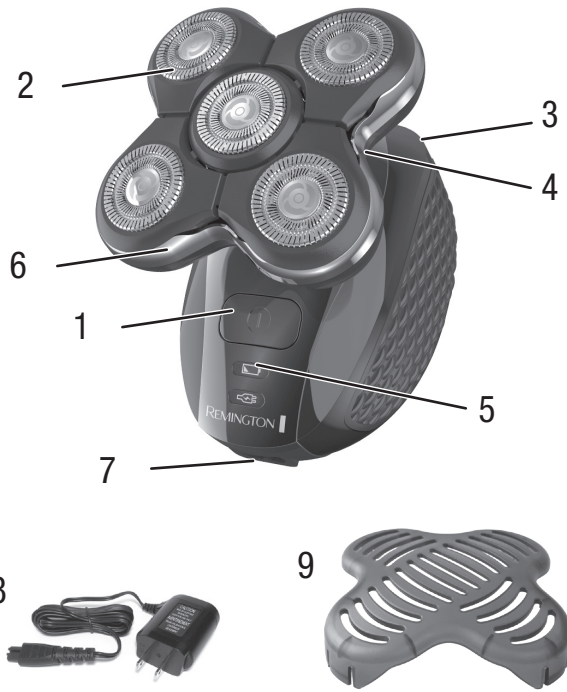

SHAVER PARTS

1. On/Off Switch
2. Shaving Head
3. Pop Up Trimmer (not shown)
4. 360° Pivoting Neck
5. LED Battery Indicators
6. Hair Pocket

7. Charging Pins
8. Power Adaptor
9. Head Guard

Also Includes (Not Shown):

- Cleaning Brush
- Shaver Lubricant

SPECIFICATIONS

Power System	Cordless
Initial Charge Time	4 Hours
Full Charge Time	4 Hours
Cordless Run Time	Up to 50 Minutes
Indicators	2 LEDs (Low / Charging / Full Charge)
Voltage Type	Worldwide 100 - 240V
Waterproof	Yes
Replacement Head and Cutters	SPR-XR7000

Power System: Cordless - shaver can only be used when disconnected from the charging adaptor. The shaver will not run while it is charging.

To preserve the life of the battery: do not charge the battery after each use. The best practice is to use the shaver until the red low charge indicator appears and then recharge.

Indicators:

- Low Charge: Flashes red when the shaver needs to be recharged.
- Charging: When plugged in, the charging indicator will light up green.
- Full Charge: Green LED indicator will turn off.

Note: Some countries will require the use of a plug adaptor that is not included with your shaver.

CHARGING

Before using, read the important safety instructions in this manual.

1. Ensure the product is switched off. Connect the shaver to the adaptor
2. Connect to a power outlet and charge for 4 hours when using for the first time. This first charge is important to the shaver's battery life.
3. When plugged in, the charging indicator will light up green.
4. When empty, the battery should be charged for 4 hours for a full charge and will provide up to 50 minutes of shaving time.
5. To preserve the life of the battery do not charge the battery after each use. Best practice is to use the shaver until the red low charge indicator appears and then recharge.

Caution:

- Make sure the shaver and your hands are dry when charging the shaver.
- Always charge the shaver in a cool, dry place.

SHAVING YOUR HEAD

GUIDELINES

- Do not attempt to shave head hair that is longer than 4 days growth or 2.0 mm. The Balder Head Shaver is intended to maintain the shaved look and can be used daily or every two or three days.
- The Balder Head Shaver cannot shave long hair down to the shaved length. If your hair is longer than 2.0 mm you should trim it down with a hair clipper first before using the head shaver.
- The Balder Head Shaver can be used dry or it can be used with shaving cream or gel in the shower.

1. Hold the head shaver body in the palm of your hand. Press the On/Off switch to turn the head shaver on.
2. Press the five cutting heads against your scalp. It is not necessary to press hard to shave. Pressing hard does not cut closer and could increase irritation. The cutting head will flex to follow the contours of your head.
3. Move the shaver slowly around your head. You may use linear strokes, or rotating motion, whichever you feel is most effective picking up and cutting your hair.
4. Use a hand held mirror to check the back of your head to confirm a complete and thorough shave. You may also use your other hand to feel for complete and consistent cutting.
5. It is not recommended to use the head shaver for facial hair.
6. When finished turn the shaver off. Check for the red low charge indication.

POP-UP TRIMMER

The pop-up trimmer is located at the back of the shaver handle. It can be used for trimming edges of beards, sideburns or ears.

1. To activate the trimmer, turn the shaver on. Slide the release button for the trimmer down to pop the trimmer up (A).
2. Use cutting strokes in the direction opposite of the trimmers spring release. (B)
3. When finished press the trimmer down and snap it back into the stored position. (C)

Note: Lubricate teeth with oil every 6 months.

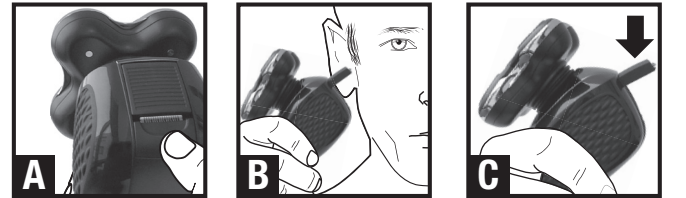

CLEANING YOUR SHAVER

The Balder Head Shaver is designed to collect all the hair clippings while it cuts. This avoids clippings from spilling onto bathroom counters or shower stalls, making clean up easy.

- When cleaning the shaver make sure it is turned off and disconnected from the charging adapter cord.
- The shaver is washable and can be cleaned by rinsing under warm water.
- When using shave creams or gels with the shaver it is especially important to clean after each use to prevent the gel from drying and clogging the cutters.

After every use:

1. Hold the shaver over the garbage can and remove the top of the cutting head. Remove the head by gripping in the areas between the four outer cutters and pulling up and away from the handle. (D)
2. Tap the excess clippings that have been collected inside the hair pocket into the garbage can. (E)
3. Rinse the cutting head thoroughly by running water through the cutters from both sides of the head.
4. Rinse the hair pocket under running water.
5. Leave the cutting head detached and let it air dry. Reattach the shaving head when dry and you are ready for the next use. (F)
6. **Important:** Lubricate the cutters on the inside surface with one drop of lubricant per cutter **once per week** to maintain performance.

CAUTION: Blades are not to be removed from the head.

Deep Clean: After rinsing away bulk debris, reassemble the razor and turn on, submerge cutter head in warm water (add soap few drops of dish soap) and run for 15 sec. Remove the shaver head from hair pocket, thoroughly rinse and brush away loosened build up.

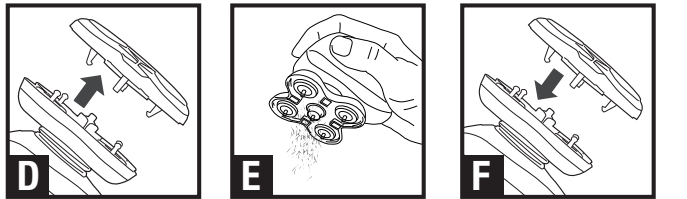

NOTE: Cleaning and lubricating before and after each use are essential with this device. Critical if wet shaving with foams or gels.

NOTE: Blades are permanently mounted in the head and are not to be removed for cleaning. Blades cannot or should not be reinstalled due to possible damage to cutter, screen, or retaining ring.

TROUBLESHOOTING

If the shaver is making a chugging noise, clean and re-lubricate the underside of the cutting heads. Be sure to clean shaver after each use and lubricate weekly.

Always firmly press the center of the on/off button when turning shaver on or off.

SHAVER REPLACEMENT PARTS

Please refer to the specifications' table in this manual that lists the correct replacement part number for your shaver. It is very important to replace the shaving heads and cutters when necessary to ensure a close, comfortable shave without irritation. We recommend they be replaced every 12 months. Here are some signs of head and cutter wear, indicating that replacement is needed:

- Irritation: As the heads get excessively worn you may experience some skin irritation. This would be especially noticeable when you apply moisturizing lotion.
- Pulling: When the cutters wear you may feel a sense of pulling and a loss of closeness when you shave. This is an indication that it is time to replace the shaving heads and cutters.



The replacement cutting head for your shaver is model number SPR-XR7000.

How to Order Parts and Accessories

- Order Online: RemingtonProducts.com

PRODUCT DISPOSAL

When your rechargeable shaver reaches the end of its useful life, the batteries must be removed from the shaver and be recycled or disposed of properly in accordance with your state and local requirements. If this is not required by law, you may elect to dispose of the shaver with the batteries.

CAUTION! Do not put in fire or mutilate your batteries when disposing as they may burst and release toxic materials. Do not short circuit as it may cause burns. Dispose of properly in accordance with your local and state requirements.

To Remove the Rechargeable Battery:

1. Unplug the shaver
2. Run shaver until the motor stops
3. Pull off the shaver head assembly.
4. Unscrew the screw on the top of the unit.
5. Pry off the upper decorative panel.
6. Pry off the two decorative side panels.
7. Unscrew the 6 screws on the inner housing.
8. Pry off the inner housing to expose the printed circuit board.
9. Take out the printed circuit board assembly.
10. Disconnect the battery from the circuit board.
11. Dispose of battery properly

At the end of this product's life, you can mail it to Spectrum Brands at 507 Stokely Drive, DeForest, WI 53532 marked "Product Takeback: Please Recycle!"

WARRANTY

Limited Five-Year Warranty

Spectrum Brands, Inc. warrants this product against any defects that are due to faulty material or workmanship for a five-year period from the original date of consumer purchase. This warranty does not include damage to the product resulting from accident or misuse.

If the product should become defective within the warranty period, we will replace it free of charge. Return your product and sales receipt with your name, address and day time phone number to: Remington Returns Center, 507 Stokely Dr., P.O. Box 1, DeForest, WI 53532. For more information call 800-736-4648 in the U.S. or Canada.

KEEP ORIGINAL SALES RECEIPT AS PROOF OF PURCHASE FOR WARRANTY PURPOSES. This warranty does not cover products damaged by the following:

- Accident, misuse, abuse or alteration of the product
- Servicing by unauthorized persons
- Use with unauthorized accessories
- Connecting it to incorrect current and voltage
- Any other conditions beyond our control

No responsibility, obligations, or liability is assumed for the installation or maintenance of this product.

SPECTRUM BRANDS, INC. SHALL NOT BE RESPONSIBLE FOR ANY INCIDENTAL, SPECIAL OR CONSEQUENTIAL DAMAGES RESULTING FROM THE USE OF THIS PRODUCT. ALL IMPLIED WARRANTIES, INCLUDING BUT NOT LIMITED TO IMPLIED WARRANTIES OF FITNESS AND MERCHANTABILITY, ARE LIMITED IN DURATION TO FIVE YEARS FROM DATE OF ORIGINAL PURCHASE.

This warranty gives you specific legal rights and you may also have other rights which vary from state to state or province to province. Some states do not allow the exclusion or limitation of incidental, special or consequential damages.

This warranty shall not be valid where it is contrary to U.S. and other applicable laws, or where the warranty would be prohibited under any economic sanctions, export control laws, embargos, or other restrictive trade measures enforced by the United States or other applicable jurisdictions. This includes, without limitation, any warranty claims implicating parties from, or otherwise located in, Cuba, Iran, North Korea, Syria and the disputed Crimea region.

Spectrum Brands, Inc. Money-back Offer

If within 30 days after you have purchased your Remington® branded product from an authorized source, you are not satisfied and would like a refund, return it with the sales receipt indicating purchase price and date of purchase to the retailer from whom it was purchased. Spectrum Brands, Inc. will reimburse all retailers who accept the product within 30 days from the date of purchase. If you have any questions concerning the money-back guarantee, please call 800-736-4648 in the U.S. or Canada.

Remington Guarantees Satisfaction After 30 Days!

Remington 60-Day Money Back Guarantee*

If within 60 days after purchasing any Remington® product, you are not completely satisfied and would like a refund, return it with the original dated sales receipt directly to Remington and receive a full refund.** For questions concerning the money-back guarantee, please call 800-736-4648 in the U.S. or Canada.

*Applies to U.S. and Canadian customers' returns only.

**Terms and conditions apply.

1. Refund will be in the form of a check issued in U.S. Dollars and will be provided only if all Terms and Conditions are met.
2. The following items must be returned to Remington and postmarked no later than 60 days after purchase of the Remington® product:
 - a. The Remington® product;
 - b. The original sales receipt indicating price and date purchased; and
 - c. The completed 60-day money back guarantee form located at **RemingtonProducts.com/60day.**
3. In addition, Remington, in its discretion, must determine that the returned product was used in accordance with the instruction booklet (included with the product at the time of purchase).
4. Returns should be mailed prepaid (no collect returns accepted) to:
Remington 60-Day MBG
507 Stokely Drive, Box 1
DeForest, WI 53532
5. Refund does not include postage costs for the return of the product, but will include applicable taxes paid by customer, if any.
6. No responsibility will be accepted for late, lost, stolen, misdirected or damaged product.
7. Please allow 4–6 weeks to receive your refund by check.

100-240V AC, 50/60Hz Type: R17A

Questions or comments: Call 800-736-4648 in the U.S. or visit **RemingtonProducts.com**.

Dist. by: Spectrum Brands, Inc., Middleton, WI 53562
© Registered Trademark and TM Trademark of Spectrum Brands, Inc.
© 2022 Spectrum Brands, Inc. All rights reserved. 10/21 28796

Made in China

T22-7002354-A